

JUNCTION BOXES

EExd, EExe

Weatherproof



Introduction

A range of small junction boxes for Zone 1 or Zone 2 use.

Available in stainless steel, marine grade alloy, galvanised cast iron, or epoxy paint coated.

Various terminals and entries can be accommodated.

- ★ Zone 1 and Zone 2 use.
- ★ EExd, EExe.
- ★ ATEX approved Ex II 2G.
- ★ BASEEFA certified.
- ★ IP66 & 67.

MEDC Ltd, Colliery Road,
Pinxton, Nottingham NG16 6JF, UK.
Tel: +44 (0)1773 864100
Fax: +44 (0)1773 582800

MEDC International, 5829 West Sam Houston Parkway,
North, Suite 1005, Houston, Texas 77041, USA.
Tel: +1 (713) 937 9772
Fax: +1 (713) 937 9773

MEDC Norway, Auglaendsmyraa 6,
4016, Stavanger, Norge.
Tel: +47 913 92 289
Fax: +47 914 46 030

Sales Enq. Fax: +44 (0)1773 582830 Sales Orders Fax: +44 (0)1773 582832
E-Mail: sales@medc.com Web: www.medc.com



6DS059/J

'e' Protection	DUST-TIGHT AND WEATHERPROOF																																			
MODEL 82e	MODEL 8DTWP																																			
<p>ATEX approved Ex II 2G. EExe IIT6. Certificate No. – Baseefa03ATEX0107X CENELEC EN 50 014 EN 50 019 Zone 1 & Zone 2.</p> <table><tr><th>Terminal Type</th><th>No. off</th><th>Max Volts</th><th>Max Amps</th><th>Max Conductor size mm²</th></tr><tr><td>BK6</td><td>6</td><td>275</td><td>21</td><td>0.5– 4.0</td></tr><tr><td>MK6/4</td><td>4</td><td>418</td><td>26</td><td>0.5–10.0</td></tr></table> <p>Weight 1.3 kg</p>	Terminal Type	No. off	Max Volts	Max Amps	Max Conductor size mm²	BK6	6	275	21	0.5– 4.0	MK6/4	4	418	26	0.5–10.0	<p>A dust-tight and waterproof version where BASEEFA Certification is not required.</p> <table><tr><th>Terminal Type</th><th>No. off</th><th>Max Volts</th><th>Max Amps</th><th>Max Conductor size mm²</th></tr><tr><td>BK6</td><td>6</td><td>440</td><td>25</td><td>0.5– 4.0</td></tr><tr><td>MK3/6</td><td>6</td><td>440</td><td>18</td><td>0.22– 2.5</td></tr><tr><td>MK6/4</td><td>4</td><td>440</td><td>31</td><td>0.5–10.0</td></tr></table> <p>Weight 1.3 kg</p>	Terminal Type	No. off	Max Volts	Max Amps	Max Conductor size mm²	BK6	6	440	25	0.5– 4.0	MK3/6	6	440	18	0.22– 2.5	MK6/4	4	440	31	0.5–10.0
Terminal Type	No. off	Max Volts	Max Amps	Max Conductor size mm²																																
BK6	6	275	21	0.5– 4.0																																
MK6/4	4	418	26	0.5–10.0																																
Terminal Type	No. off	Max Volts	Max Amps	Max Conductor size mm²																																
BK6	6	440	25	0.5– 4.0																																
MK3/6	6	440	18	0.22– 2.5																																
MK6/4	4	440	31	0.5–10.0																																

Ambient Temperature:	-20°C to +40°C.
Entry Sizes:	Max. one per face in 20mm or 25mm ISO.
Material:	Cast iron body, stainless steel cover screws, neoprene gasket.
Finish:	Either hot dipped galvanised or epoxy painted.
Ordering Details:	See reverse side.
Ingress Protection:	IP66 & 67.

Model 82e

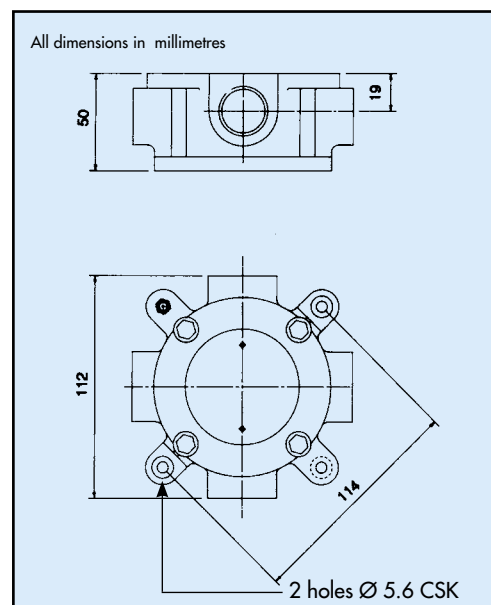

Ordering Requirements

The following code is designed to help in the selection of the correct unit. Build up the reference number by inserting the code for each component into the appropriate box. **Standard products, available ex-stock, as follows:**

Product	Description
SM87JBA1T1B1R1L11NG	SM87 Junction Box, EExd IIC T6, Zones 1 & 2, BK6 terminals, 4 x 20mm entries, 1 per face, marine grade alloy, painted grey.
82E1T1B1R1L11NG	82E Junction Box, EExe II T6, Zones 1 & 2, BK6 terminals, 4 x 20mm entries, 1 per face, cast iron, painted grey.

Junction Box	Entries	Terminals	Tag/Duty Label	Finish																																																																									
<div> <div></div> <table border="1"> <thead> <tr> <th>Model</th> </tr> </thead> <tbody> <tr><td>82E</td></tr> <tr><td>8DTWP</td></tr> <tr><td>SM87JBA (alloy)</td></tr> <tr><td>SM87JBS (stainless steel)</td></tr> </tbody> </table> </div>	Model	82E	8DTWP	SM87JBA (alloy)	SM87JBS (stainless steel)	<div> <div></div> <table border="1"> <thead> <tr> <th>Entries</th> <th>Code</th> </tr> </thead> <tbody> <tr><td>20mm</td><td>1</td></tr> <tr><td>25mm</td><td>2</td></tr> <tr><td>Other please specify</td><td>3</td></tr> <tr><td>Top</td><td>*T</td></tr> <tr><td>Bottom</td><td>*B</td></tr> <tr><td>RHS</td><td>*R</td></tr> <tr><td>LHS</td><td>*L</td></tr> <tr><td colspan="2">*prefix position with entry size code. e.g. 1T1B=20mm Top and Bottom entries.</td></tr> </tbody> </table> </div>	Entries	Code	20mm	1	25mm	2	Other please specify	3	Top	*T	Bottom	*B	RHS	*R	LHS	*L	*prefix position with entry size code. e.g. 1T1B=20mm Top and Bottom entries.		<div> <div></div> <table border="1"> <thead> <tr> <th>Terminal</th> <th>Code</th> </tr> </thead> <tbody> <tr><td>BK6</td><td>11</td></tr> <tr><td>MK3/10</td><td>12</td></tr> <tr><td>AKZ 4</td><td>13</td></tr> <tr><td>SAKD2.5N</td><td>14</td></tr> <tr><td>SAK2.5</td><td>15</td></tr> <tr><td>SAK4</td><td>16</td></tr> <tr><td>MBK</td><td>21</td></tr> <tr><td>MBK5</td><td>22</td></tr> <tr><td>MBK6</td><td>23</td></tr> <tr><td>BK4</td><td>24</td></tr> <tr><td>AK16</td><td>26</td></tr> <tr><td>MK6/4</td><td>28</td></tr> <tr><td>MK3/6</td><td>29</td></tr> </tbody> </table> </div>	Terminal	Code	BK6	11	MK3/10	12	AKZ 4	13	SAKD2.5N	14	SAK2.5	15	SAK4	16	MBK	21	MBK5	22	MBK6	23	BK4	24	AK16	26	MK6/4	28	MK3/6	29	<div> <div></div> <table border="1"> <thead> <tr> <th>Label</th> <th>Code</th> </tr> </thead> <tbody> <tr><td>None</td><td>N</td></tr> <tr><td>Yes</td><td>Y</td></tr> <tr><td colspan="2">please specify in text.</td></tr> </tbody> </table> </div>	Label	Code	None	N	Yes	Y	please specify in text.		<div> <div></div> <table border="1"> <thead> <tr> <th>Finish</th> <th>Code</th> </tr> </thead> <tbody> <tr><td>Red</td><td>R</td></tr> <tr><td>Blue</td><td>B</td></tr> <tr><td>Yellow</td><td>Y</td></tr> <tr><td>Yellow/Black Stripes</td><td>X</td></tr> <tr><td>Grey</td><td>G</td></tr> <tr><td>other or special finish please specify</td><td>S</td></tr> </tbody> </table> </div>	Finish	Code	Red	R	Blue	B	Yellow	Y	Yellow/Black Stripes	X	Grey	G	other or special finish please specify	S
Model																																																																													
82E																																																																													
8DTWP																																																																													
SM87JBA (alloy)																																																																													
SM87JBS (stainless steel)																																																																													
Entries	Code																																																																												
20mm	1																																																																												
25mm	2																																																																												
Other please specify	3																																																																												
Top	*T																																																																												
Bottom	*B																																																																												
RHS	*R																																																																												
LHS	*L																																																																												
*prefix position with entry size code. e.g. 1T1B=20mm Top and Bottom entries.																																																																													
Terminal	Code																																																																												
BK6	11																																																																												
MK3/10	12																																																																												
AKZ 4	13																																																																												
SAKD2.5N	14																																																																												
SAK2.5	15																																																																												
SAK4	16																																																																												
MBK	21																																																																												
MBK5	22																																																																												
MBK6	23																																																																												
BK4	24																																																																												
AK16	26																																																																												
MK6/4	28																																																																												
MK3/6	29																																																																												
Label	Code																																																																												
None	N																																																																												
Yes	Y																																																																												
please specify in text.																																																																													
Finish	Code																																																																												
Red	R																																																																												
Blue	B																																																																												
Yellow	Y																																																																												
Yellow/Black Stripes	X																																																																												
Grey	G																																																																												
other or special finish please specify	S																																																																												



All the above specifications, dimensions, weights and tolerances are nominal (typical) and MEDC reserve the right to vary all data without prior notice. No liability is accepted for any consequence of use.