

CONTROL UNITS EExed and Weatherproof GHG 411, 432 & 434 Range



Introduction

This range of control stations, intended for use in potentially explosive atmospheres, is suitable for use in all gas groups including hydrogen. (Except Acetylene Class I, Zone 1)

These rugged enclosures are manufactured from a UV stable, impact resistant polyamide; cover fixing screws are stainless steel thus ensuring a corrosion-free product.

The GHG 411 range comprises a 1, 2 and 3 way unit offering a compact footprint. The GHG 432 and 434 ranges are 2 and 4 way units with larger termination area for heavy duty offshore cable.

The high ingress protection rating makes this range of control stations suitable for use in harsh environmental conditions.

- ★ Zones 1, 2 and safe area.
- ★ EExed IIC T6.
- ★ ATEX approved Ex II 2GD.
- ★ PTB Certified.
- ★ UL Listed for USA and Canada.
 - Class I, Div 2, Groups A-D
 - Class I, Zone 1, AExde IIB+H₂ T6
 - Class II, Div 1, Groups E, F&G(cUL)
- ★ IP65/66*.
- ★ Certified Temperature -20°C to +40°C*.
- ★ Impact resistant thermoplastic.
- ★ Retained stainless steel cover screws.
- ★ Variety of components.
- ★ Variety of enclosures.

*Depending on version.

MEDC Ltd, Colliery Road,
Pinxton, Nottingham NG16 6JF, UK.
Tel: +44 (0)1773 864100
Fax: +44 (0)1773 582800

MEDC International, 5829 West Sam Houston Parkway,
North, Suite 1005, Houston, Texas 77041, USA.
Tel: +1 (713) 937 9772
Fax: +1 (713) 937 9773

MEDC Norway, Auglaendsmyrå 6,
4016, Stavanger, Norge.
Tel: +47 913 92 289
Fax: +47 914 46 030

Sales Enq. Fax: +44 (0)1773 582830 Sales Orders Fax: +44 (0)1773 582832
E-Mail: sales@medc.com Web: www.medc.com



Specification

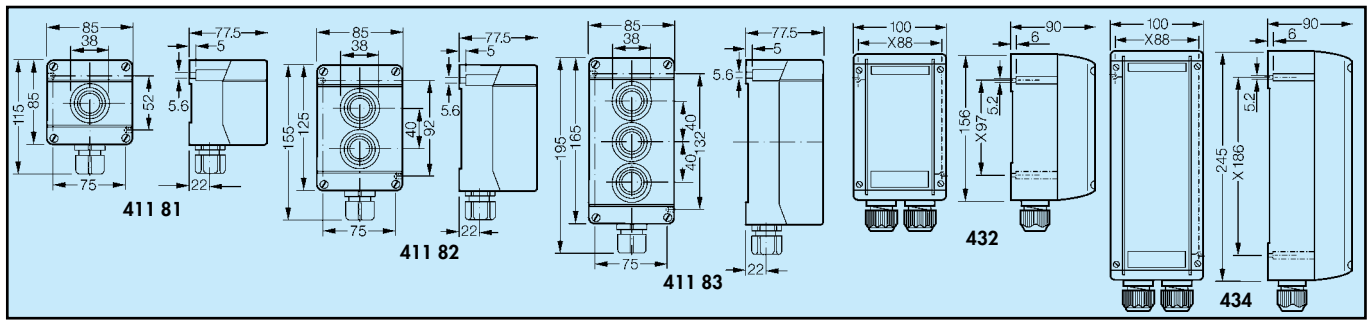

Certification:	CENELEC EN50014, 18, 19 & 20. Certificate No. PTB 00 ATEX 3117. EExed IIC T6 (T _{amb} 48°C). Zones 1 & 2. UL Listed for USA and Canada Class I, Div 2, Groups A-D. Class I, Zone 1, AExde IIB+H ₂ T6 and Class II, Div 1, Groups E,F&G(cUL). Listing No. E194809.
Material:	Impact resistant thermoplastic, anti-static enclosure with stainless steel cover screws.
Finish:	Self coloured black.
Weight:	From 0.5kg to 1.3kg (411 Range) From 0.8kg to 1.6kg (432 & 434 Range)
Operating Temperatures:	-20°C to +40°C (UL version). See separate European datasheet for ATEX operating temperatures.
Ingress Protection:	IP66 (IP65 for double pushbutton).
Termination:	2.5mm ² max. direct to components. Alternatively pre-wired to a 6 way terminal block accepting up to 4mm ² conductors. Max voltage rating 400V.
Function Labelling:	Each cover component can have a function label as extra.
Duty/Tag Labelling:	Duty or tag labels are self adhesive.
Earthing:	Internal earth terminal is provided as standard. For 411 range, for enclosures with two entries in one face gland earth continuity is provided via gland plate. For enclosures with one entry in opposite faces gland earth continuity is optional. For 432 & 434 range, gland earth continuity is optional for one and two entries per bottom or top face.
Entries:	411 Range 1 x 20mm entry bottom as standard. 2 x 20mm entries on bottom face available via brass gland continuity plate. 432 & 434 Range 2 x 20mm entries in bottom as standard (one blanking plug as standard).
Multi-way units:	Enclosures can be coupled together. Please contact sales office.
Actuator Types:	Spring return pushbutton, mushroom head emergency stop, mushroom head momentary, double pushbutton, key operated switches, mini control switch and rotary switches.
Signal Lamps:	Available in two voltage ranges: Universal voltage 20V-250V AC/DC (current consumption 4-15mA). Low voltage 12V-30V AC/DC (maximum current consumption 24mA). Lamp colours available: white, yellow, red, blue, green.
Options/accessories:	Lift flap, function label, terminal block, potentiometer, duty/tag labels. Contact sales office to order.

Typical configurations: 411 81 range



411 81...01



411 81...18



411 81...12



411 81...04

Built-in components	Weight Approx.	Order No.*
1 x pushbutton, 1NO + 1NC, label: O, I, START, STOP	0.40kg	GHG 411 8195 R0001
1 x mushroom head latching, 1NO + 1NC, "Emergency stop"	0.45kg	GHG 411 8195 R0002
1 x mushroom head latching, with key release, 1NO + 1NC, "Emergency stop"	0.50kg	GHG 411 8195 R0012
1 x double pushbutton, 1NO + 1 NC, label: O, I, START, STOP	0.45kg	GHG 411 8195 R0009
1 x key operated switch, 2NO I - O - II	0.52kg	GHG 411 8195 R0018
1 x control switch, 1 x change-over, label: HAND-AUTO	0.45kg	GHG 411 8195 R0003
label: O - I	0.45kg	GHG 411 8195 R0004
label: I - II	0.45kg	GHG 411 8195 R0005
1 x control switch, 2 NO, label: HAND - O - AUTO	0.45kg	GHG 411 8195 R0006
label: I - O - II	0.45kg	GHG 411 8195 R0007
label: Local Remote Auto	0.45kg	GHG 411 8195 R0008

*Note: Ordering codes are for ATEX compliant units only – for UL listed units contact sales office.

Typical configurations: 411 82 range



411 82...01



411 82...03



411 82...17



411 82...18

Built-in components	Weight Approx.	Order No.*
2 x pushbutton, 1NO + 1NC each, label: O, I, START, STOP	0.54kg	GHG 411 8295 R0001
1 x signal lamp, 20-254V AC/DC, lens cover; white, red, green, yellow		
1 x double pushbutton, 1NO + 1NC, label: O, I, START, STOP	0.65kg	GHG 411 8295 R0003
1 x double pushbutton, 1NO + 1NC, label: O, I, START, STOP		
1 x mushroom head latching, 1NO + 1NC, "Emergency stop"	0.57kg	GHG 411 8295 R0016
1 x control switch, 1 x change-over, label: O - I		
1 x mushroom head latching, 1NO + 1NC, "Emergency stop"	0.57kg	GHG 411 8295 R0017
1 x signal lamp, 20-254V AC/DC, lens cover: white, red, green, yellow,		
1 x key operated switch, 2 NO, label: I - O - II	0.65kg	GHG 411 8295 R0008

*Note: Ordering codes are for ATEX compliant units only – for UL listed units contact sales office.

Typical configurations: 411 83 range



411 83...01



411 83...03



411 83...04

Built-in components	Weight Approx.	Order No.*
1 x signal lamp, 20-254V AC/DC, lens cover: white, red, green, yellow		
2 x pushbutton, 1NO + 1NC each, label: O, I, START, STOP	0.76kg	GHG 411 8395 R0001
1 x signal lamp, 20-254V AC/DC, lens cover; white, red, green, yellow		
1 x double pushbutton, 1NO + 1NC, label: O, I, START, STOP		
1 x mushroom head latching, 1NO + 1NC, "Emergency stop"	0.80kg	GHG 411 8395 R0003
1 x signal lamp, 20-254V AC/DC, lens cover: white, red, green, yellow		
1 x double pushbutton, 1NO + 1NC, label: O, I, START, STOP		
1 x key operated switch, 1 change-over, label: HAND-AUTO	0.65kg	GHG 411 8395 R0004

*Note: Ordering codes are for ATEX compliant units only – for UL listed units contact sales office.

For other options contact sales office.

Typical configurations: 432 range



432...01



432...02



432...03

Built-in components

- 2 x pushbutton, 1NO + 1NC each, label: O, I, START, STOP
- 1 x signal lamp, 20-254V AC/DC, lens cover; white, red, green, yellow
- 1 x double pushbutton, 1NO + 1NC, label: O, I, START, STOP
- 1 x double pushbutton, 1NO + 1NC, label: O, I, START, STOP
- 1 x mushroom head latching, 1NO + 1NC, "Emergency stop"

Weight Approx.

Order No.*

- 0.85kg GHG 432 0095 R0001
- 0.90kg GHG 432 0095 R0002
- 0.85kg GHG 432 0095 R0003

*Note: Ordering codes are for ATEX compliant units only – for UL listed units contact sales office.

Typical configurations: 434 range



434...04



434...05



434...09

Built-in components

- 1 x signal lamp, 20-254V AC/DC, lens cover; white, red, green, yellow
- 2 x pushbutton, 1NO + 1NC each, label: O, I, START, STOP
- 1 x mushroom head latching, 1NO + 1NC, "Emergency stop"
- 2 x signal lamp, 20-254V AC/DC, lens cover; white, red, green, yellow
- 2 x double pushbutton, 1NO + 1NC each, label: O, I, START, STOP
- 1 x signal lamp, 20-254V AC/DC, lens cover; white, red, green, yellow
- 1 x double pushbutton, 1NO + 1NC, label: O, I, START, STOP
- 1 x mushroom head latching, 1NO + 1NC, "Emergency stop"
- 1 x key operated switch, 2NO, label: I - O - II

Weight Approx.

Order No.*

- 1.45kg GHG 434 1195 R0004
- 1.45kg GHG 434 1195 R0005
- 1.55kg GHG 434 1195 R0009

*Note: Ordering codes are for ATEX compliant units only – for UL listed units contact sales office.

For other options contact sales office.



All the above specifications, dimensions, weights and tolerances are nominal (typical) and MEDC reserve the right to vary all data without prior notice. No liability is accepted for any consequence of use.