

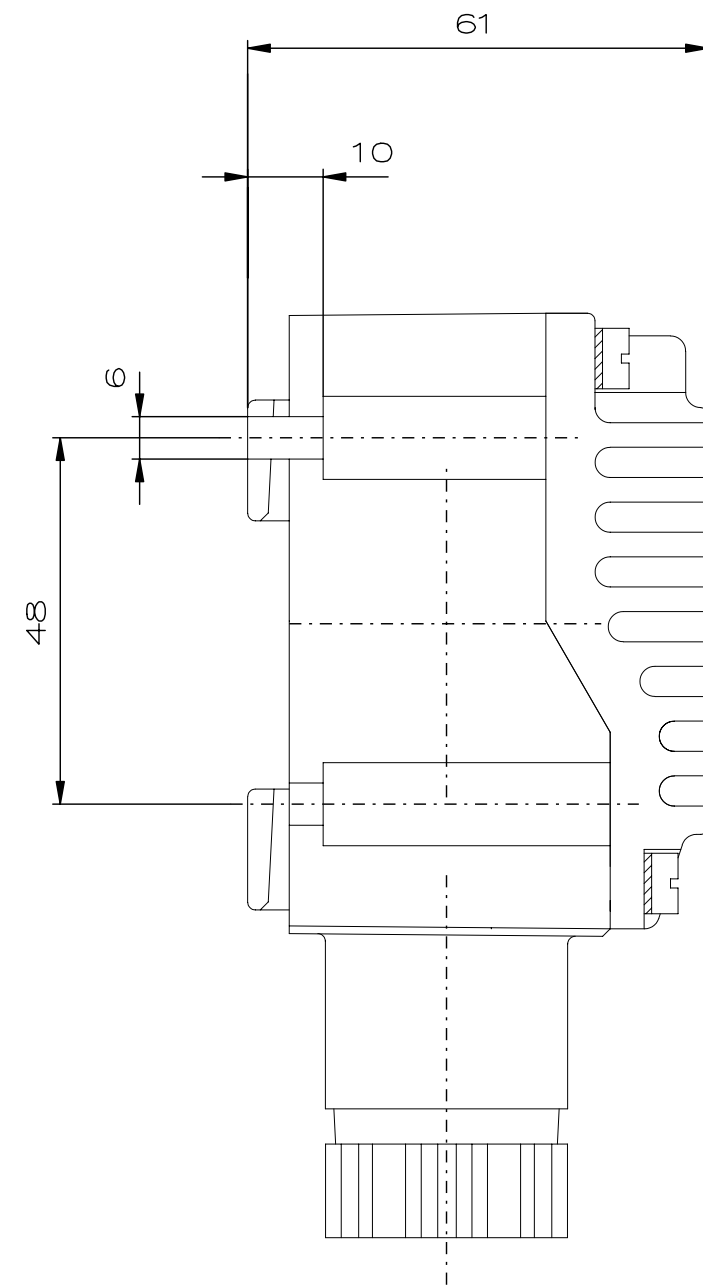

Designed with CAD-System ESP32

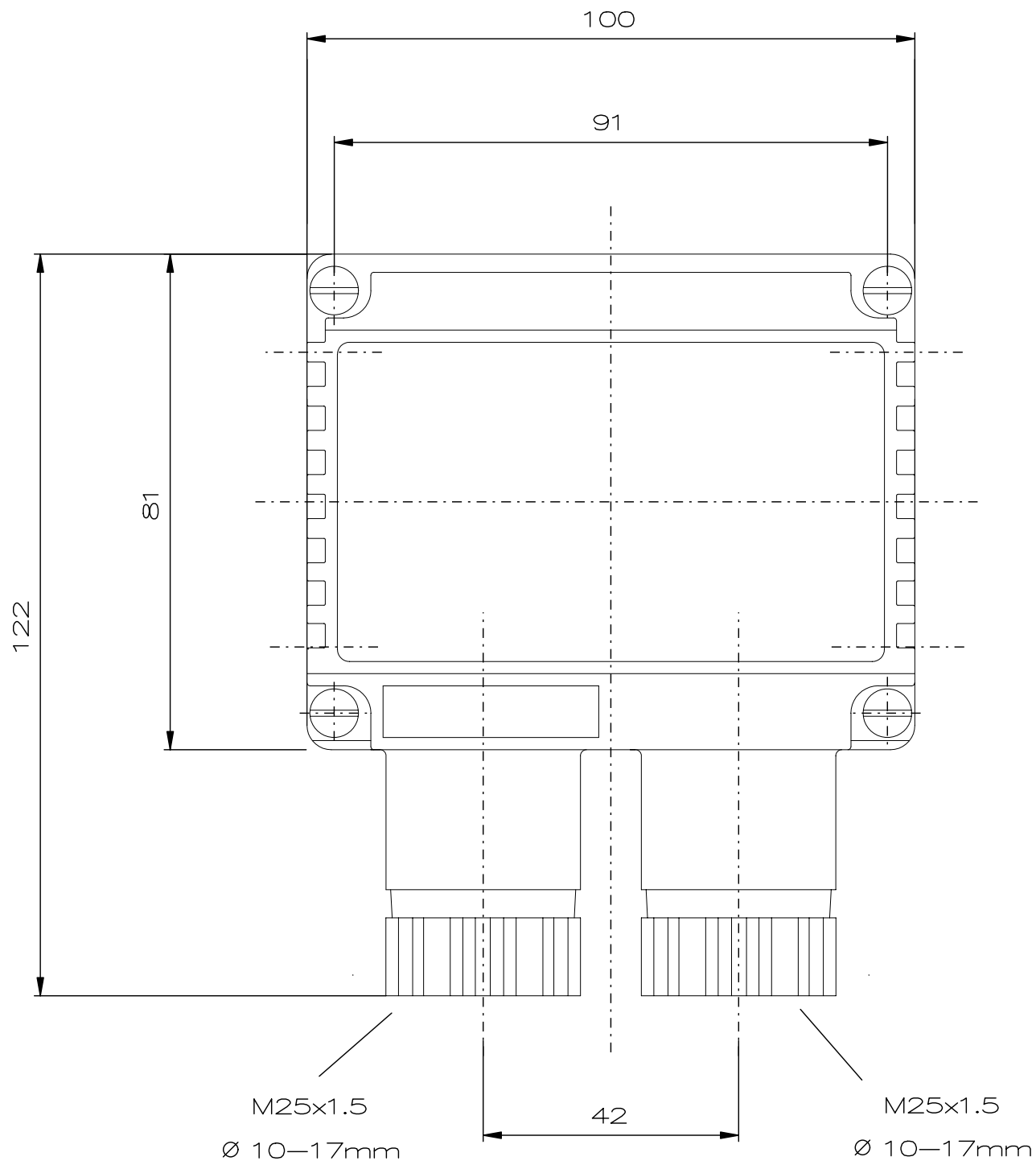

"Schutzvermerk nach DIN 34 beachten" / "Copyright reserved"

Description: Junction box Ex-e 791 01 2 x M25

Beschreibung: Abzweigdose Ex-e 791 01 2 x M25



Rev.st/ Zust.	Revision/ Änderung	Date/ Datum	Name/ Name

Date/ Datum	17.10.2008
Expert/ Bearbeiter	Röther
1:1	Dimension unit: mm Maßeinheit: mm

Material-No.:/ Material-Nr.:

GHG7910101R0001