



**Technical data**

| AB 12108-EVG  |   |
|---|---|
| Marking to 94/9/EC<br>(new standard – applies for)                              | ⊕ II 2 G EEx d IIC T6/T5 / ⊕ II 2 D T 58 °C (T <sub>a</sub> up to 40 °C) T 73 °C (T <sub>a</sub> up to 55 °C) <sup>1)</sup><br>⊕ II 2 G Ex d IIC T5/T6 / ⊕ II 2 D Ex tD A21 IP67 T73 °C |
| EC-Type Examination Certificate   | LOM 02 ATEX 2013 X  |
| Permissible ambient temperature   | -20 °C up to +55 °C   |
| Rated voltage 1   | 230 V AC  |
| Rated voltage 2   | 220 V DC +25 %/-20 %  |
| Frequency   | 50 Hz   |
| Rated power consumption   | approx. 16 VA   |
| Connecting terminals  | L1, N and PE: 2 x 2.5 mm <sup>2</sup> / PE ext.: 2 x 6 mm <sup>2</sup>  |
| Insulation class  | I   |
| Lamp/Illuminant   | 1 x 8 W/T5-fluorescent lamp for mains and emergency operation   |
| Lamp cap  | G5  |
| Luminous flux Φ <sub>E</sub> /Φ <sub>N</sub> at the end of rated operating time | 75 %  |
| Viewing distance with legend  | up to approx. 15 m  |
| Degree of protection accd. EN 60529   | IP67  |
| Cable glands/gland plates/enclosure drilling                                    | direct entries: see ordering details  |
| Dimensions (L x W x H)  | 460 x 144 x 140 mm  |
| Weight  | approx. 5.3 kg  |
| Enclosure material  | copper-free aluminium   |
| Protective cover/protective bowl  | borosilicat-glass   |
| EE11 PL   |   |
| Marking to 94/9/EC<br>(new standard – applies for)                              | ⊕ II 2 G EEx d IIC T6 / ⊕ II 2 D T 58 °C<br>⊕ II 2 G Ex d IIC T5/T6 / ⊕ II 2 D Ex tD A21 IP67 T73 °C  |
| EC-Type Examination Certificate   | LOM 03 ATEX 2036 X  |
| Permissible ambient temperature   | -5 °C up to +40 °C  |
| Rated voltage 1   | 220 V - 240 V AC  |
| Rated voltage (option)  | 108 V - 127 V AC  |
| Frequency   | 50 - 60 Hz  |
| Rated power consumption   | approx. 16 VA   |
| Connecting terminals  | L1, N and PE: 2 x 2.5 mm <sup>2</sup> / PE ext.: 2 x 6 mm <sup>2</sup>  |
| Insulation class  | I   |
| Lamp/Illuminant   | 1 x 11 W compact-fluorescent lamp for emergency operation   |
| Pilot lamp  | 3 W – GLS for permanent operation   |
| Lamp cap of 11 W C FL   | socket 2G7  |
| Luminous flux in emergency operation  | approx. 70 % after 1.5 h  |
| Viewing distance with legend  | up to approx. 15 m  |
| Battery   | nickel-cadmium 4 Ah   |
| Rated operating in emergency  | 1.5 h   |
| Charging duration   | 24 h  |
| Degree of protection accd. EN 60529   | IP67  |
| Cable glands/gland plates/enclosure drilling                                    | see ordering details, eXLink inlet on request   |
| Dimensions (L x W x H)  | 460 x 144 x 140 mm  |
| Weight  | approx. 5.6 kg  |
| Enclosure material  | copper-free aluminium   |
| Protective cover/protective bowl  | borosilicat-glass   |
| Function indication   | red LED      battery charging<br>green LED    main connection   |

Note: EE11PL Luminaire must not be opened in hazardous area.

<sup>1)</sup> Marking accd. new standard applies for

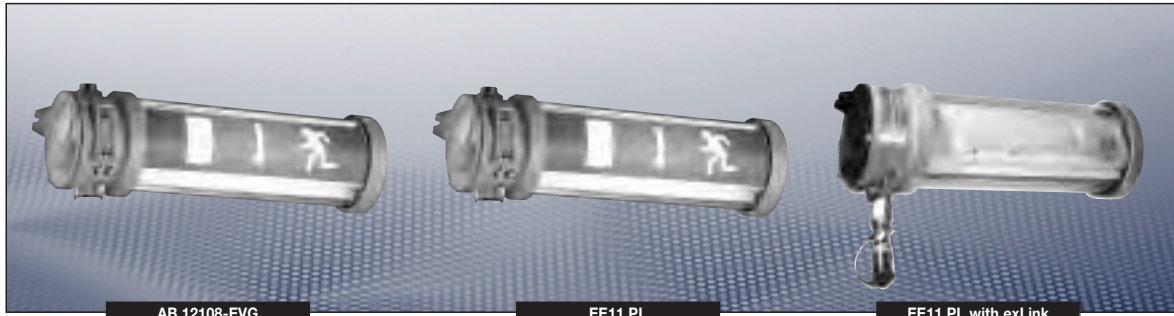

AB 12108-EVG

EE11 PL

EE11 PL with exLink

## Ordering details

| Type               | Rated voltage    | Thread   | Cable gland<br>Ex-d for Ø 9 - 14 mm | Blanking plug<br>Ex-d | Ordering Code              |
|--------------------|------------------|----------|-------------------------------------|-----------------------|----------------------------|
| <b>AB12108-EVG</b> |                  |          |                                     |                       |                            |
| AB12108-EVG        | 220 - 230 V AC / | 2 x 3/4" | 1 x 3/4"                            | 1 x 3/4"              | <b>NOR 000 005 060 837</b> |
| AB12108-EVG        | 195 - 250 V DC   | 2 x 3/4" | -                                   | 1 x 3/4"              | <b>NOR 000 005 060 820</b> |
| <b>EE11 PL</b>     |                  |          |                                     |                       |                            |
| EE11PL             | 220 - 240 V AC   | 2 x 3/4" | 1 x 3/4"                            | 1 x 3/4"              | <b>NOR 000 005 160 012</b> |
|                    |                  | 2 x 3/4" | -                                   | 1 x 3/4"              | <b>NOR 000 005 160 013</b> |
| EE11PL             | 108 - 127 V DC   | 2 x 3/4" | 1 x 3/4"                            | 1 x 3/4"              | <b>NOR 000 005 160 015</b> |
|                    |                  | 2 x 3/4" | -                                   | 1 x 3/4"              | <b>NOR 000 005 160 014</b> |

## Accessories

### Ex-Emergency luminaires AB 12108-EVG and EE11 PL

| Type   | Ordering Code              |
|--|----------------------------|
| Ceiling bracket D 92 with screws and polyamide washer (CrNi, 2 pcs.) | <b>2 2480 092 000</b>      |
| Ceiling bracket A5 hot galvanized (1 pc.)                            | <b>NOR 000 005 009 162</b> |
| Wall bracket 45° hot galvanized (1 pc.)                              | <b>NOR 000 005 009 196</b> |
| Reflector RAB 108 (AISI 304)   | <b>NOR 003 045 060 471</b> |
| Reflector RAB 108 (AISI 304) + guard (steel white epoxy coating)     | <b>NOR 003 045 060 819</b> |
| Reflector RAB 108 (AISI 316)   | <b>NOR 003 165 060 471</b> |
| Reflector RAB 108 (AISI 316) + guard (steel white epoxy coating)     | <b>NOR 003 165 060 819</b> |

### Lamps for Ex-emergency and signal light fittings

| For luminaire<br>Type | Lamp type/<br>lamp cap/diameter | Lamp power | rated luminous flux<br>approx. | Ordering Code         |
|-----------------------|---------------------------------|------------|--------------------------------|-----------------------|
| AB 12108-EVG          | T5, socket G5, Ø 16 mm          | 8 W        | 450 lm                         | <b>4 0040 004 623</b> |
| EE11 PL               | TC-SEL, 4-pin socket 2G7        | 11 W       | 900 lm                         | <b>on request</b>     |



**Dimension drawing | Polar curves | Accessories**

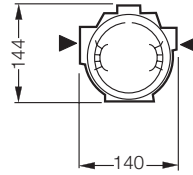
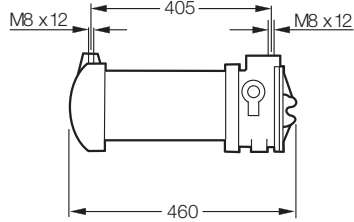

AB 12108-EVG / EE11 PL

**Polar curve**  
AB 12108-EVG / EE11 PL

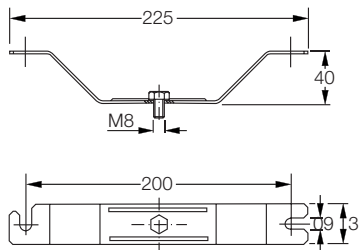
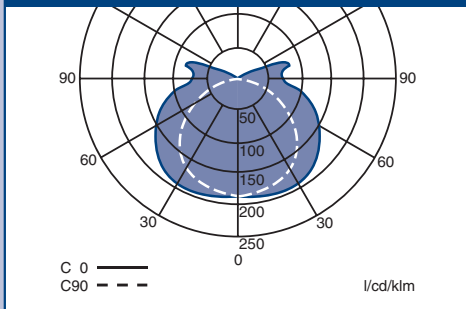

**Ceiling bracket D92**

Cooper Crouse-Hinds © 2009 - all rights reserved

Dimensions in mm

- 1
- 2
- 3
- 4
- 5
- 6
- 7
- 8
- 9
- 10
- 11
- 12