

# Safety luminaire

## 3503.1 ... 3604.1 LED CG-S

EN  
1838



IP20

CG-S

- Safety luminaire in LED technology for recessed mounting with round or quadratic bezel
- Typical ceiling cut out diameter of 68 mm and low profile of only 30 mm\*)
- Compact housing for LED-Supply (required height for entering the ceiling only 100 mm) including through wiring clamp and strain relief
- Up to 15 m from luminaire to luminaire for escape route illumination
- Up to 14 m from luminaire to luminaire for open area illumination
- Minimum service requirement due to high service life of the LEDs (50 000 hours)
- Shortened inspection effort due to CEWA GUARD technology
- Automatic function monitoring of up to 20 luminaires per circuit
- Reduced installation expenditures by STAR technology
- Freely programmable mixed operation of the switching modes per luminaire in one circuit

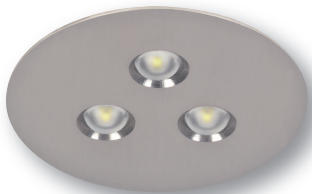

3503.1 LED CG-S stainless steel



3503.1 LED CG-S white

Dimensions in mm

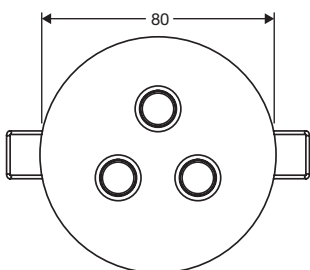

3503.1 LED CG-S

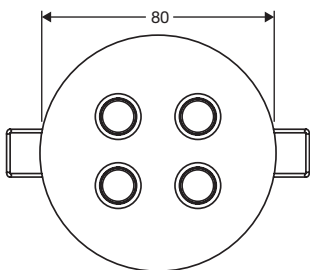

3504.1 LED CG-S

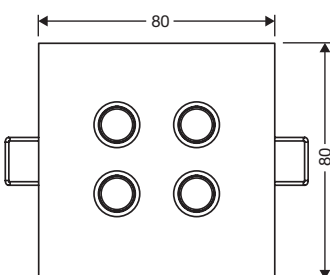

3604.1 LED CG-S

|  |           |  |
|--|-----------|--|
| Luminous flux $\Phi_E/\Phi_N$ at the end of rated operating time     |           | 100 %  |
| Enclosure material   | Bezel     | Stainless steel brushed / sheet steel, white (sim. RAL 9010)         |
|  | Module    | Polycarbonate  |
| Weight   | Luminaire | 0.13 kg  |
|  | Module    | 0.12 kg (incl. enclosure)  |
| Type of mounting   |           | Ceiling recessed mounting  |
| Connection terminals   |           | Loop terminals 3 x 2.5 mm <sup>2</sup>                               |
| Voltage  |           | 220 - 240 V, 50/60 Hz  |
|  |           | 176 V - 275 V DC   |
| Current consumption battery operating                                | 3503.1:   | 19 mA  |
|  | 3x04.1:   | 25 mA  |
| Power consumption mains operation (apparent power / effective power) | 3503.1:   | 7.6 VA / 4.4 W   |
|  | 3x04.1:   | 9.5 VA / 5.8 W   |
| Permissible temperature range  |           | -10 °C up to +40 °C  |
| Lamp   |           | 3503.1: HighPower LEDs 3 x 1.1 W<br>3x04.1: HighPower LEDs 4 x 1.1 W |

### Ordering details

| Type                   | Scope of supply  | Order No.      |
|------------------------|--|----------------|
| 3503.1 stainless steel | Round LED recessed luminaire with wide beam optics, 3 x HighPowerLED, including LED supply and CG-S technology (20 addresses) in housing with strain relief, bezel stainless steel brushed     | 4 0071 352 900 |
| 3503.1 white           | Round LED recessed luminaire with wide beam optics, 3 x HighPowerLED, including LED supply and CG-S technology (20 addresses) in housing with strain relief, bezel white                       | 4 0071 352 901 |
| 3504.1 stainless steel | Round LED recessed luminaire with wide beam optics, 4 x HighPowerLED, including LED supply and CG-S technology (20 addresses) in housing with strain relief, bezel stainless steel brushed     | 4 0071 352 904 |
| 3504.1 white           | Round LED recessed luminaire with wide beam optics, 4 x HighPowerLED, including LED supply and CG-S technology (20 addresses) in housing with strain relief, bezel white                       | 4 0071 352 905 |
| 3604.1 stainless steel | Quadratic LED recessed luminaire with wide beam optics, 4 x HighPowerLED, including LED supply and CG-S technology (20 addresses) in housing with strain relief, bezel stainless steel brushed | 4 0071 352 908 |
| 3604.1 white           | Quadratic LED recessed luminaire with wide beam optics, 4 x HighPowerLED, including LED supply and CG-S technology (20 addresses) in housing with strain relief, bezel white                   | 4 0071 352 909 |

\*) 45 mm until approx. 09/2010

# Safety luminaire

## 3503.1 ... 3604.1 LED CG-S

### Engineering help for 3503.1 LED CG-S for E = 1.0 lx (0.5 lx)

Measuring level: 0.02 m, Maintenance factor MF = 80 %, battery operation

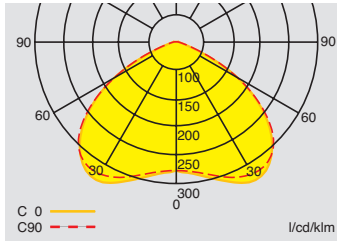

| Mounting height (m) | Type of mounting       | L1 [m]    |             | L2 [m]    |             | L3 [m]    |           | L4 [m]    |           |
|---------------------|------------------------|-----------|-------------|-----------|-------------|-----------|-----------|-----------|-----------|
|                     |                        | Diagram 1 | Diagram 2   | Diagram 1 | Diagram 2   | Diagram 1 | Diagram 2 | Diagram 1 | Diagram 2 |
| 2.5                 | Ceiling mounting       | 3.9 (4.6) | 9.1 (10.4)  | 3.9 (4.6) | 9.1 (10.5)  |           |           |           |           |
| 3.0                 | Escape route centre    | 4.2 (5.1) | 10.1 (11.7) | 4.2 (5.1) | 10.1 (11.8) |           |           |           |           |
| 3.5                 |                        | 4.4 (5.5) | 10.9 (12.8) | 4.5 (5.5) | 10.9 (12.9) |           |           |           |           |
| 4.0                 |                        | 4.6 (5.8) | 11.5 (13.8) | 4.6 (5.8) | 11.5 (13.8) |           |           |           |           |
| 4.5                 |                        | 4.7 (6.0) | 12.0 (14.7) | 4.7 (6.1) | 12.1 (14.7) |           |           |           |           |
| 5.0                 |                        | 4.7 (6.3) | 12.4 (15.4) | 4.7 (6.3) | 12.5 (15.4) |           |           |           |           |
| 5.5                 |                        | 4.6 (6.4) | 12.8 (16.1) | 4.6 (6.5) | 12.9 (16.1) |           |           |           |           |
| 6.0                 |                        | 4.5 (6.5) | 13.0 (16.6) | 4.5 (6.6) | 13.1 (16.7) |           |           |           |           |
| 6.5                 |                        | 4.3 (6.6) | 13.1 (17.1) | 4.1 (6.7) | 13.3 (17.2) |           |           |           |           |
| 7.0                 |                        | 3.9 (6.6) | 13.2 (17.5) | 3.6 (6.7) | 13.3 (17.7) |           |           |           |           |
| 7.5                 |                        | 2.9 (6.6) | 13.1 (17.9) | 2.6 (6.6) | 13.1 (18.0) |           |           |           |           |
| 2.5                 | Ceiling mounting       | 3.4 (3.4) | 7.2 (8.4)   | 3.5 (4.5) | 7.4 (8.2)   |           |           |           |           |
| 3.0                 | Open area illumination | 3.4 (4.4) | 8.2 (9.4)   | 3.5 (4.5) | 8.2 (9.4)   |           |           |           |           |
| 3.5                 |                        | 3.4 (4.4) | 9.0 (10.4)  | 4.5 (4.5) | 9.0 (10.2)  |           |           |           |           |
| 4.0                 |                        | 3.4 (4.4) | 9.8 (11.4)  | 4.5 (5.5) | 9.6 (11.2)  |           |           |           |           |
| 4.5                 |                        | 3.4 (4.4) | 10.4 (12.2) | 4.5 (5.5) | 10.2 (12.0) |           |           |           |           |
| 5.0                 |                        | 3.4 (4.4) | 11.0 (13.0) | 4.5 (5.5) | 10.8 (12.8) |           |           |           |           |
| 5.5                 |                        | 3.4 (4.4) | 11.4 (13.6) | 4.5 (6.5) | 11.2 (13.6) |           |           |           |           |
| 6.0                 |                        | 3.4 (5.4) | 11.8 (14.2) | 4.5 (5.5) | 11.6 (14.2) |           |           |           |           |
| 6.5                 |                        | 3.4 (5.4) | 12.2 (14.8) | 3.5 (5.5) | 12.0 (14.8) |           |           |           |           |
| 7.0                 |                        | 3.0 (5.4) | 12.4 (15.4) | 2.9 (5.5) | 12.4 (15.2) |           |           |           |           |
| 7.5                 |                        | 2.0 (5.4) | 12.6 (15.8) | 1.9 (5.5) | 12.6 (15.8) |           |           |           |           |

### Engineering help for 3504.1/3604.1 LED CG-S for E = 1.0 lx (0.5 lx)

Measuring level: 0,02 m, Maintenance factor MF = 80 %, battery operation

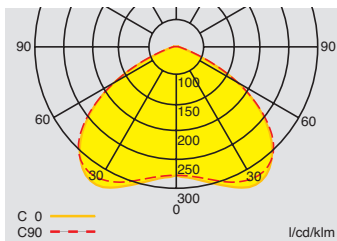

| Mounting height (m) | Type of mounting       | L1 [m]    |             | L2 [m]    |             | L3 [m]    |           | L4 [m]    |           |
|---------------------|------------------------|-----------|-------------|-----------|-------------|-----------|-----------|-----------|-----------|
|                     |                        | Diagram 1 | Diagram 2   | Diagram 1 | Diagram 2   | Diagram 1 | Diagram 2 | Diagram 1 | Diagram 2 |
| 2.5                 | Ceiling mounting       | 4.2 (4.9) | 9.7 (11.0)  | 4.2 (4.9) | 9.7 (11.1)  |           |           |           |           |
| 3.0                 | Escape route centre    | 4.6 (5.4) | 10.8 (12.3) | 4.6 (5.4) | 10.8 (12.5) |           |           |           |           |
| 3.5                 |                        | 4.8 (5.9) | 11.7 (13.6) | 4.9 (5.9) | 11.7 (13.7) |           |           |           |           |
| 4.0                 |                        | 5.1 (6.3) | 12.5 (14.7) | 5.1 (6.3) | 12.5 (14.7) |           |           |           |           |
| 4.5                 |                        | 5.2 (6.6) | 13.1 (15.7) | 5.3 (6.6) | 13.1 (15.7) |           |           |           |           |
| 5.0                 |                        | 5.3 (6.9) | 13.7 (16.6) | 5.4 (6.9) | 13.7 (16.6) |           |           |           |           |
| 5.5                 |                        | 5.4 (7.1) | 14.1 (17.4) | 5.4 (7.1) | 14.2 (17.4) |           |           |           |           |
| 6.0                 |                        | 5.4 (7.3) | 14.5 (18.1) | 5.4 (7.3) | 14.6 (18.1) |           |           |           |           |
| 6.5                 |                        | 5.3 (7.4) | 14.8 (18.7) | 5.3 (7.5) | 14.9 (18.8) |           |           |           |           |
| 7.0                 |                        | 5.2 (7.5) | 15.0 (19.2) | 5.1 (7.6) | 15.1 (19.3) |           |           |           |           |
| 7.5                 |                        | 4.9 (7.6) | 15.1 (19.7) | 4.7 (7.7) | 15.3 (19.8) |           |           |           |           |
| 8.0                 |                        | 4.5 (7.6) | 15.2 (20.1) | 4.2 (7.7) | 15.3 (20.3) |           |           |           |           |
| 8.5                 |                        | 3.7 (7.6) | 15.1 (20.5) | 3.3 (7.6) | 15.2 (20.7) |           |           |           |           |
| 2.5                 | Ceiling mounting       | 3.4 (3.4) | 7.6 (8.8)   | 3.5 (4.5) | 7.8 (8.6)   |           |           |           |           |
| 3.0                 | Open area illumination | 3.4 (4.4) | 8.8 (9.8)   | 4.5 (4.5) | 8.6 (9.8)   |           |           |           |           |
| 3.5                 |                        | 3.4 (4.4) | 9.6 (11.0)  | 4.5 (5.5) | 9.6 (10.8)  |           |           |           |           |
| 4.0                 |                        | 4.4 (4.4) | 10.4 (12.0) | 4.5 (5.5) | 10.4 (11.8) |           |           |           |           |
| 4.5                 |                        | 4.4 (5.4) | 11.2 (12.8) | 4.5 (5.5) | 11.0 (12.8) |           |           |           |           |
| 5.0                 |                        | 4.4 (5.4) | 11.8 (13.8) | 4.5 (5.5) | 11.6 (13.6) |           |           |           |           |
| 5.5                 |                        | 4.4 (5.4) | 12.4 (14.4) | 4.5 (6.5) | 12.2 (14.4) |           |           |           |           |
| 6.0                 |                        | 4.4 (5.4) | 12.8 (15.2) | 4.5 (6.5) | 12.8 (15.2) |           |           |           |           |
| 6.5                 |                        | 4.4 (5.4) | 13.2 (16.0) | 4.5 (6.5) | 13.2 (15.8) |           |           |           |           |
| 7.0                 |                        | 4.4 (5.4) | 13.6 (16.6) | 4.5 (6.5) | 13.6 (16.4) |           |           |           |           |
| 7.5                 |                        | 3.4 (5.4) | 14.0 (17.2) | 4.5 (6.5) | 13.8 (17.0) |           |           |           |           |
| 8.0                 |                        | 3.4 (5.4) | 14.2 (17.6) | 3.5 (6.5) | 14.2 (17.6) |           |           |           |           |
| 8.5                 |                        | 2.4 (5.4) | 14.4 (18.2) | 3.5 (6.5) | 14.6 (18.0) |           |           |           |           |

# Safety luminaire

## 3503.1 ... 3604.1 LED CG-S

Dimensions in mm

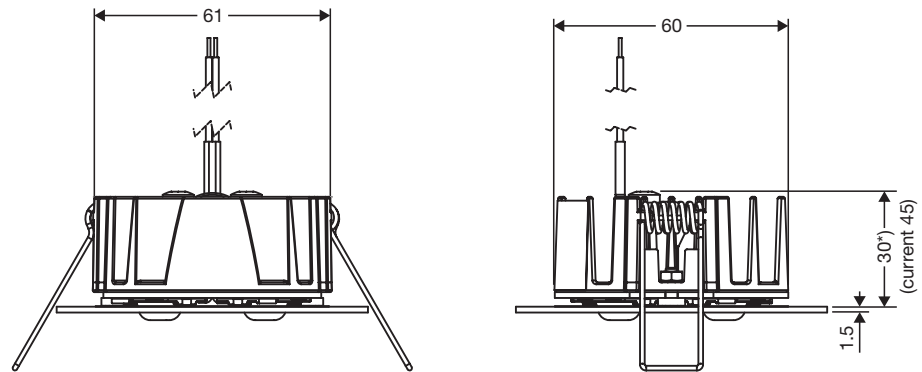

Ceiling cut out: D = 68 mm

<sup>1)</sup> Drawing already shows version with diecast heat sink, available from 10/2010!

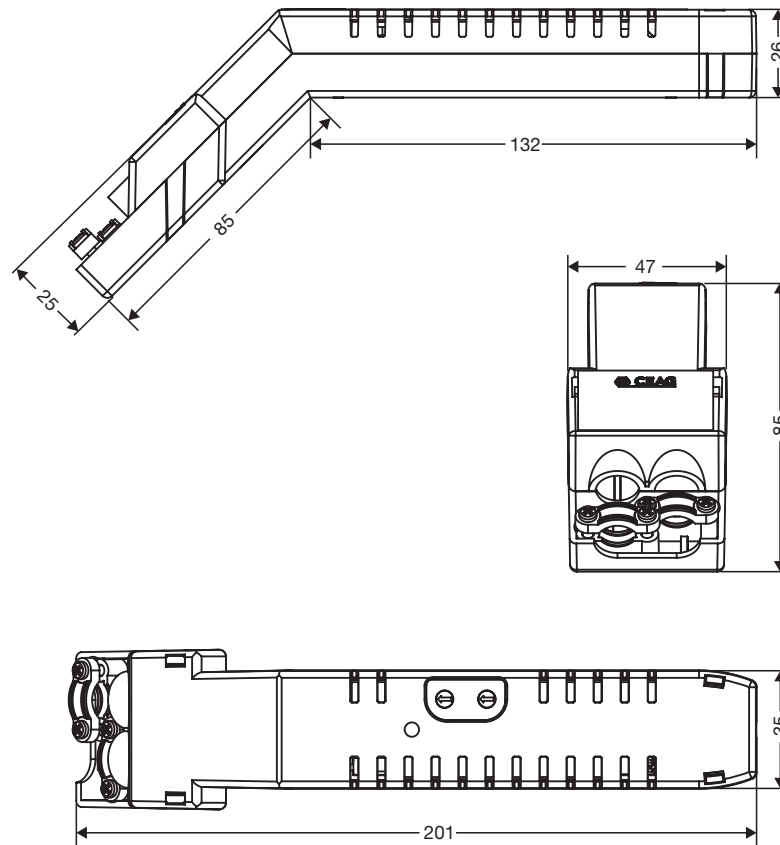

Module housing